



**DBA SILENCING**  
4917 BURDE ST. PORT ALBERNI, BC V9Y 3J5

DBASILENCING.CA  
INFO@DBASILENCING.CA  
1-800-661-5886

# EXHAUST KITS

## KOMATSU 830E

### CUMMINS K2000 ENGINE TO HORSE COLLAR INSULATED EXHAUST SYSTEM

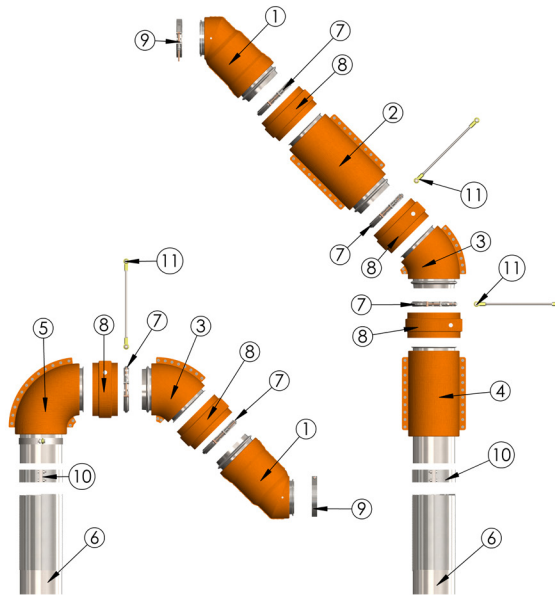

LABEL #	PART #	DESCRIPTION	QTY
1	EXK-01	10" 45° Slashcut Pipe With Bellows	2
2	EXK-02	10" Straight Pipe	1
3	EXK-03	10" Standard 45° Elbow	2
4	EXK-04	10" Straight Pipe	1
5	EXK-05	10" 90° Elbow With Leg	1
6	EXK-06	10" Diameter Stainless Steel Flex Pipe 24" Long	2
7	VB10	10" V-Band Clamp	5
8	VS10	10" Insulated V-Band Clamp Cover	5
9	VB8	8" V-Band Clamp	2
10	FBC10	10" Stainless Steel Flat Band Clamp	2
11	EXH18	18" Exhaust Hanger	3
	<b>EXK2831S</b>	<b>COMPLETE EXHAUST SYTEM</b>	<b>1</b>

**Note:** Our standard kits come with ridged and flared connections, which are easy to install. For an additional cost, we can provide machine flange connections that are stronger and more compatible with some OEM systems.