



DBA SILENCING
4917 BURDE ST. PORT ALBERNI, BC V9Y 3J5

DBASILENCING.CA
INFO@DBASILENCING.CA
1-800-661-5886

EXHAUST KITS

KOMATSU 830E

FENDER MOUNT BEHIND HORSE COLLAR INSULATED EXHAUST SYSTEM

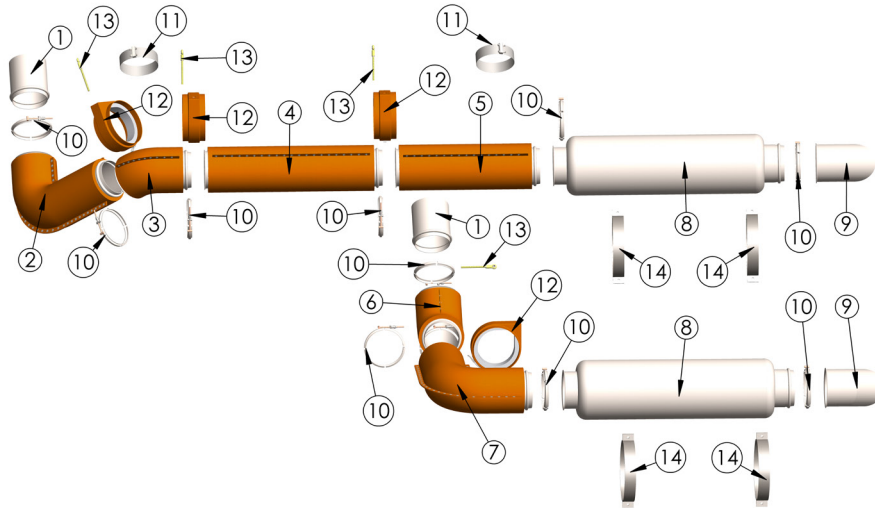

| LABEL # | PART # | DESCRIPTION | QTY |
|---------|----------------|-------------------------------------|----------|
| 1 | AD10 | 10" Flex Pipe Adaptor | 2 |
| 2 | 83FME-1 | 10" 90° Elbow With Leg | 1 |
| 3 | 83FME-2 | 10" 45° Elbow With Leg | 1 |
| 4 | 83FME-3 | 10" Straight Mid Pipe 46.5" Long | 1 |
| 5 | 83FME-4 | 10" Straight Mid Pipe 37.5" Long | 1 |
| 6 | 83FME-5 | 10" 45° Elbow With Short Leg | 1 |
| 7 | 83FME-6 | 10" 90° Elbow To Muffler | 1 |
| 8 | EXMV1610 | 16" Diameter Muffler | 2 |
| 9 | EXS10 | 10" Muffler Down Spout | 2 |
| 10 | VB10 | 10" V-Band Clamp | 10 |
| 11 | FBC10 | 10" Stainless Steel Flat Band Clamp | 2 |
| 12 | VS10 | 10" Insulated V-Band Clamp Cover | 4 |
| 13 | EXH18 | 18" Exhaust Hanger | 4 |
| 14 | MB16 | 16" Muffler Mounting Bracket | 4 |
| | 83FMEIS | COMPLETE EXHAUST SYSTEM | 1 |

Note: Our standard kits come with ridged and flared connections, which are easy to install. For an additional cost, we can provide machine flange connections that are stronger and more compatible with some OEM systems.