



DBA SILENCING
4917 BURDE ST. PORT ALBERNI, BC V9Y 3J5

DBASILENCING.CA
INFO@DBASILENCING.CA
1-800-661-5886

EXHAUST KITS

KOMATSU 930E

930E-2 FENDER MOUNT DETROIT DIESEL 16V 4000 INSULATED EXHAUST SYSTEM

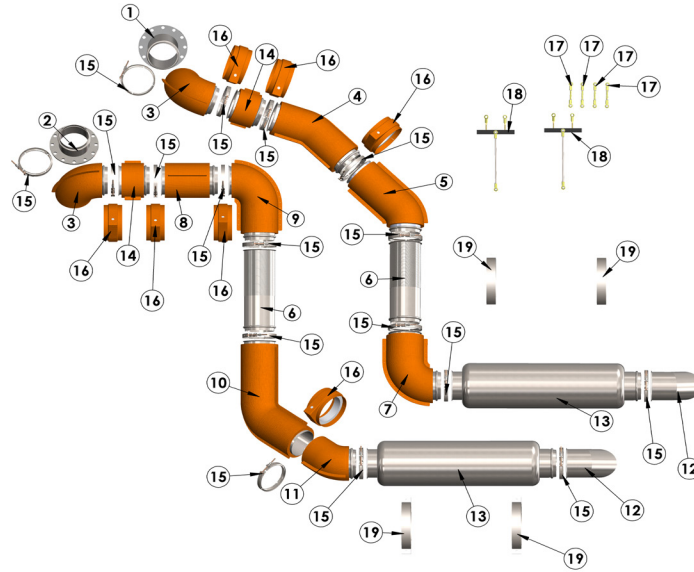

LABEL #	PART #	DESCRIPTION	QTY
1	930-16DF-01	11" Flanged Turbo Pipe	1
2	930-16DF-02	5" Flanged Turbo Pipe	1
3	930-16DF-03	10" Standard 90° Elbow	2
4	930-16DF-04	10" 30° Elbow With Leg	1
5	930-16DF-05	10" 59° Elbow	1
6	930-16DF-06	10" Stainless Steel Flex Pipe	2
7	930-16DF-07	10" 90° Elbow With Leg	1
8	930-16DF-08	10" Straight Pipe	1
9	930-16DF-09	10" 90° Elbow With Leg	1
10	930-16DF-10	10" 59° Elbow With Leg	1
11	930-16DF-11	10" 45° Elbow With Leg	1
12	EXS10	10" Muffler Down Spout	2
13	EXMV1610	16" Diameter Muffler	2
14	BC10	10" Bellows Pipe	2
15	VB10	10" V-Band Clamp	17
16	VS10	10" Insulated V-Band Clamp Cover	7
17	EXH18	18" Exhaust Hanger	4
18	BCH10	10" Bellows Hanger Kit	2
19	MB16	16" Muffler Bracket	4
	930-16DF	COMPLETE EXHAUST SYSTEM	1

Notes: This system runs from the engine compartment to the horse collar. Both banks go to the right side of the horse collar. Our standard kits come with ridged and flared connections, which are easy to install. For an additional cost, we can provide machine flange connections that are stronger and more compatible with some OEM systems.