



**DBA SILENCING**  
4917 BURDE ST. PORT ALBERNI, BC V9Y 3J5

DBASILENCING.CA  
INFO@DBASILENCING.CA  
1-800-661-5886

# EXHAUST KITS

## KOMATSU 930E

### CUMMINS QSK 60 STAGE TWO ENGINE TO UPPER HEATED BOX INSULATED EXHAUST SYSTEM

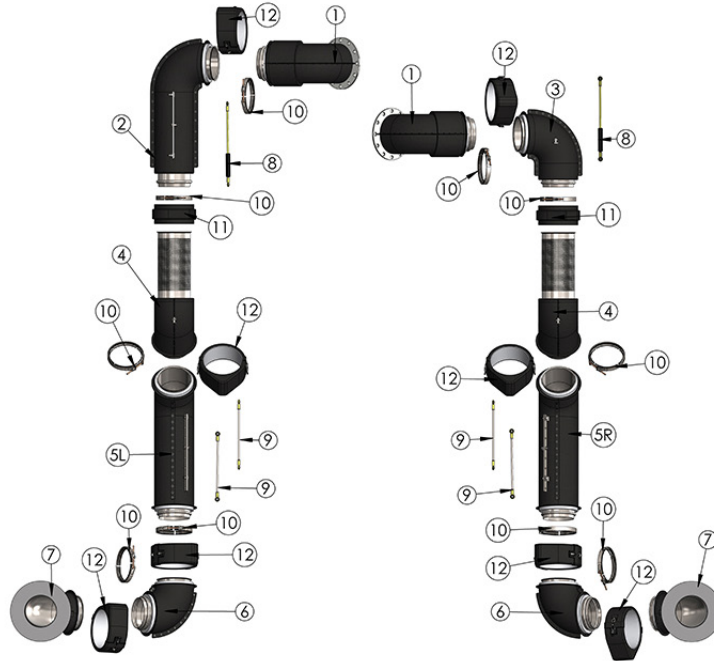

LABEL #	PART #	DESCRIPTION	QTY
1	930QSKNCP-01	10" 60° Flanged Turbo Bellows Pipe	2
2	930QSKNCP-02	10" 90° Elbow With Long Leg	1
3	930QSKNCP-03	90° Elbow With Short Leg	1
4	930QSKNCP-04	47° Via Horse Collar Pipe	2
5L	930QSKNCP-05L	55° Mid Pipe Driver Side	1
5R	930QSKNCP-05R	55° Mid Pipe Passenger Side	1
6	930QSKNCP-06	90° To Upper Heated Box	2
7	930QSKNCP-07	65° To Upper Heated Box	2
8	SHN001	Pre-Loaded Spring Hanger	2
9	EXH36	36" Exhaust Hanger	4
10	VB10	10" V-Band Clamp	10
11	HCV10	Horse Collar Clamp Cover	2
12	NSVS210	Two-Piece 10" Insulated V-Band Clamp Cover	8
	<b>930QSK2</b>	<b>COMPLETE EXHAUST SYSTEM</b>	<b>1</b>

**Note:** Our standard kits come with ridged and flared connections, which are easy to install. For an additional cost, we can provide machine flange connections that are stronger and more compatible with some OEM systems.